

© This drawing must not be reproduced in whole or in part without the express written consent of Badingham Ltd.

NOTES

1. THESE NOTES ARE TO BE REFERRED TO THROUGHOUT THE DESIGN PACK 0495.
2. ALL DIMENSIONS ARE IN METRES UNLESS OTHERWISE STATED.
3. TOPOGRAPHICAL SURVEY INFORMATION PROVIDED BY OTHERS. BADINGHAM CANNOT BE HELD RESPONSIBLE FOR ANY INACCURACIES
4. LEVELS ARE IN METRES AND RELATE TO OS GPS DATUM.
5. THIS DRAWING IS TO BE READ IN CONJUNCTION WITH ALL DRAWINGS, NOTES AND SPECIFICATION FROM THE BADINGHAM DESIGN PACK 0495. THE CONTRACTOR IS TO SATISFY THEMSELVES THAT THERE ARE NO DISCREPANCIES WITHIN THE DESIGN PACK BEFORE COMMENCING ON SITE. IF IN DOUBT ASK.
6. ALL WORKS TO BE CARRIED OUT IN STRICT ACCORDANCE WITH "THE SPECIFICATION FOR HIGHWAY WORKS - MODIFIED & EXTENDED", INCLUDING SWINDON BOROUGH COUNCIL'S SUPPLEMENTARY CLAUSES.
6. ALL WORKS SHALL BE COMPLETED TO THE SATISFACTION OF THE SWINDON BOROUGH COUNCIL (SBC) ENGINEER.
7. ALL WORKS WITHIN THE PUBLIC HIGHWAY SHALL BE CARRIED OUT AND COMPLY WITH THE REQUIREMENTS OF THE DTP "TRAFFIC SIGNS MANUAL CHAPTER 8 - TRAFFIC MEASURES AND SIGNS FOR LAND WORKS AND TEMPORARY SITUATIONS".
8. ALL ROAD MARKINGS AND TRAFFIC SIGNS SHALL COMPLY WITH "THE TRAFFIC SIGNS REGULATIONS AND GENERAL DIRECTIONS 2002".
9. ALL EXISTING LEVELS TO BE CONFIRMED ON SITE PRIOR TO COMMENCEMENT OF ANY WORKS.
10. THE CONTRACTOR SHALL MAINTAIN ACCESS TO ALL PROPERTIES AFFECTED BY THE WORKS.
11. THE CONTRACTOR SHALL CONTACT ALL UTILITIES COMPANIES PRIOR TO COMMENCING AND EXCAVATION. IT IS THE CONTRACTOR'S RESPONSIBILITY TO LOCATE THE EXACT POSITION OF ALL UNDERGROUND AND OVERHEAD SERVICES, CABLES, PIPES ETC PRIOR TO THE EXCAVATIONS AND TO TAKE ALL NECESSARY PROTECTIVE MEASURES.
12. THE CONTRACTOR SHALL MAKE GOOD ANY DAMAGE CAUSED TO WALLS, FENCES, KERBING, SURFACING, ROAD SIGNS ETC AT HIS OWN EXPENSE AS INSTRUCTED BY THE ENGINEER AND HIGHWAY AUTHORITY.
13. THE CONTRACTOR SHALL INDEMNIFY THE CLIENT, ENGINEER AND HIGHWAY AUTHORITY AGAINST DAMAGE TO ANY HIGHWAY AUTHORITY PROPERTY OR STATUTORY UNDERTAKERS' PLANT AND ANY COSTS ASSOCIATED WITH THE DISRUPTION OF SERVICES AND THE REPAIR/REPLACEMENT OF THE DAMAGED PLANT. NO WORK ON SITE SHALL COMMENCE UNTIL WRITTEN EVIDENCE OF THE ABOVE INDEMNITY HAS BEEN SUBMITTED TO AND ACCEPTED BY THE ENGINEER.
14. ALL WORKS TO BE UNDERTAKEN IN COMPLIANCE WITH PROJECT SPECIFICATION & TO SBC APPROVAL.
15. ANY DISCREPANCIES BETWEEN PROJECT SPECIFICATION & SBC REQUIREMENTS TO BE REPORTED IMMEDIATELY TO THE ENGINEER.
16. TRIAL HOLES ARE TO BE DUG PRIOR TO WORKS COMMENCING TO IDENTIFY THE SUITABILITY OF ANY STREET LIGHTING COLUMNS PROPOSED LOCATIONS.

B	RED LINE BOUNDARY ADDED	AD	AKD	24.05.16
A	ACCESS TO NORTHERN SITE ADDED	AD	AKD	16.05.16
Rev	Description	Dim	Chk	Date

REVISIONS

Badingham

Concept | Consult | Construct
Transport & Infrastructure Consultants
T. +44(0)203 056 9626 www.badinghamuk.com

Project
**CATSBRAIN FARM
S278 AGREEMENT WORKS**

Client
**CASTLEWOOD COMMERCIAL
PROPERTIES LTD**

Title
**SCHEME LAYOUT
RESERVE MATTERS**

Status
FOR APPROVAL

Scale	Date	Drawn	Checked
1:500	05/02/16	AD	AKD
Job No	Drawing No	Revision	
0495	0495-002	B	

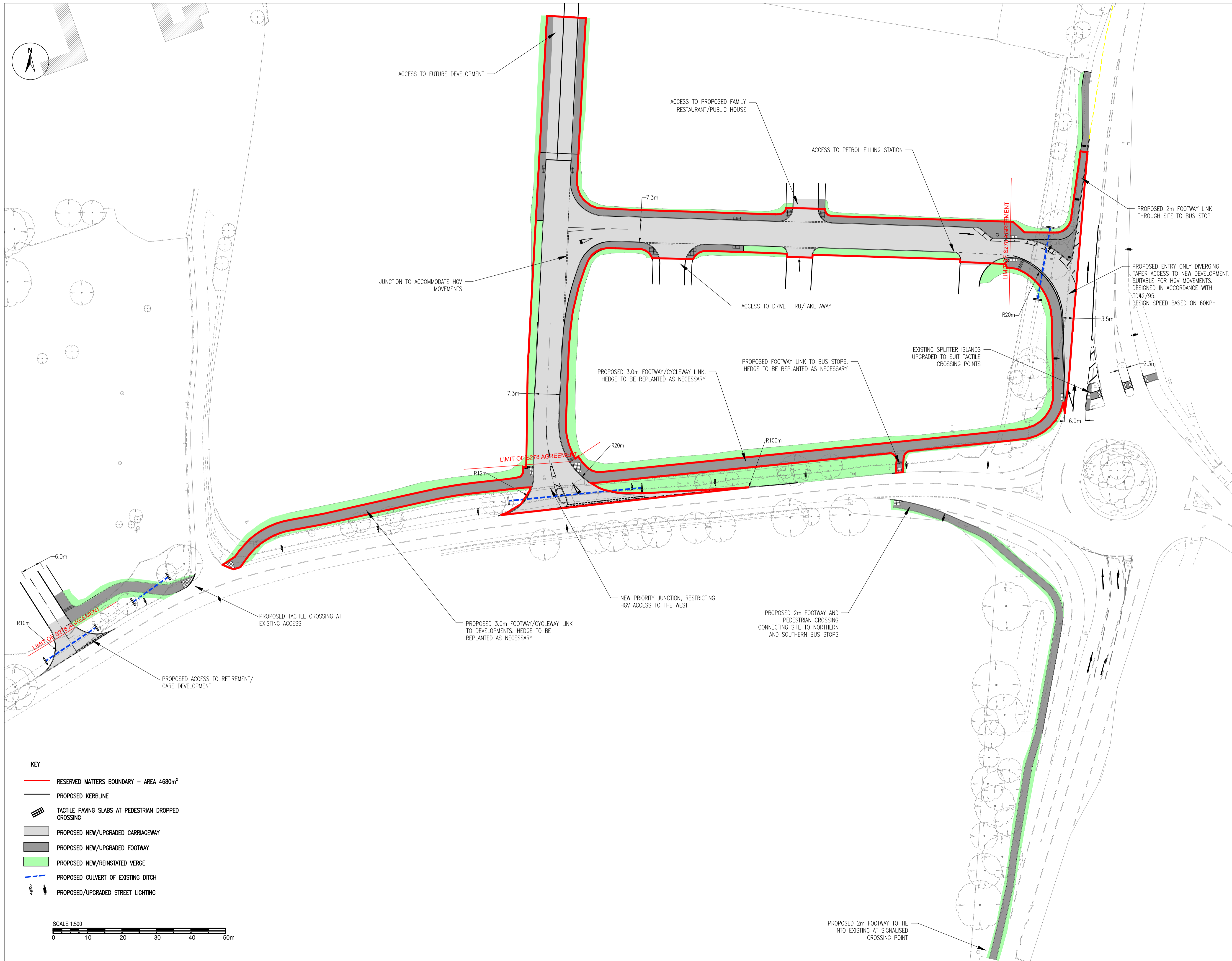

- KEY**
- RESERVED MATTERS BOUNDARY - AREA 4680m²
 - PROPOSED KERBLINE
 - TACTILE PAVING SLABS AT PEDESTRIAN DROPPED CROSSING
 - PROPOSED NEW/UPGRADED CARRIAGEWAY
 - PROPOSED NEW/UPGRADED FOOTWAY
 - PROPOSED NEW/REINSTATED VERGE
 - PROPOSED CULVERT OF EXISTING DITCH
 - PROPOSED/UPGRADED STREET LIGHTING

