

KEY
 BUILDINGS TO BE DEMOLISHED

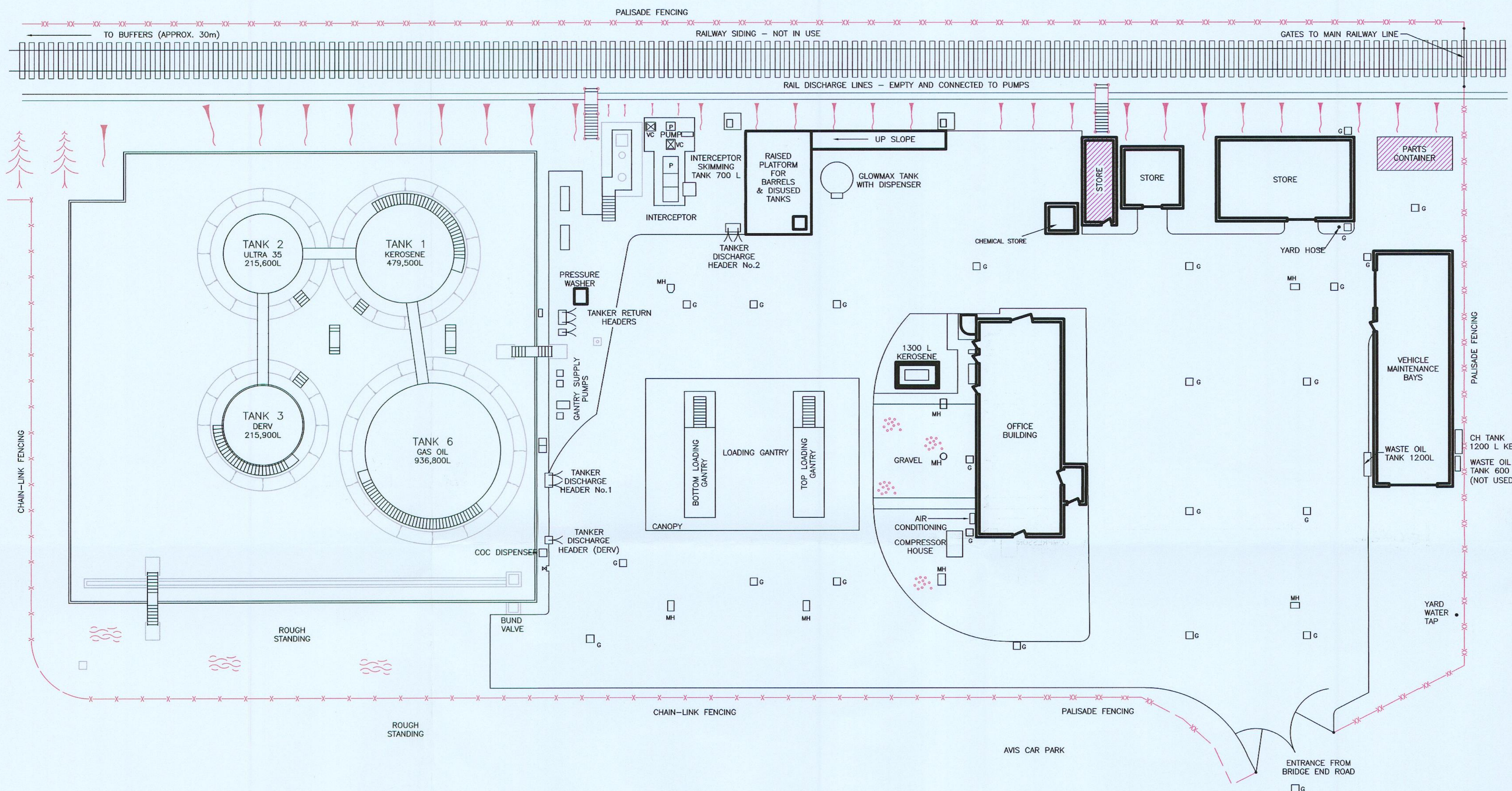

SITE LAYOUT
SCALE 1:200

Rev:	Date:	FIRST ISSUE	Rev By:	Chk:	Appr:
A	JUN 16		SM	CH	NM
Revision Details:					

certas energy
Certas Energy UK Ltd
 302 Bridgewater Place
 Birchwood Park
 Warrington
 Cheshire WA3 6XG

THIS DRAWING IS CONFIDENTIAL AND THE INFORMATION CONTAINED HEREIN IS A CONFIDENTIAL DISCLOSURE. IT IS SHOWN ON THE UNDERSTANDING THAT IT IS NOT TO BE REVEALED TO OTHERS OR USED FOR ANY OTHER PURPOSE WITHOUT THE WRITTEN CONSENT OF TRIDENT ENGINEERING CONSULTANTS / CERTAS ENERGY UK LTD.

trident engineering consultants
 Swindon Borough Council Planning Department
 - 3 JUN 2016
 S. Benfield 9914

Consulting Engineers • Design & Project Management • Quantity Surveyors
 Cost Control & Analysis
 GATEHOUSE OFFICES, WESTWAY, PORTERFIELD ROAD, RENFREW,
 PA4 8DJ SCOTLAND
 Telephone: +44 (0) 141 561 2282 Fax: +44 (0) 141 561 2259 E-mail: info@tridenteng.net
www.tridenteng.net

Site: EMO OILS - SWINDON DEPOT

Title: SITE LAYOUT

Dwg By: SM Checked: CH Approved: NM
 Date: JUN 16 Date: JUN 16 Date: JUN 16

Scale: AS SHOWN @ A1 Drawing No: 5138-001 Rev: A