



Durrington For Sale

LOT 10

Coloured Red on Plan

All that Fertile Arable Land

comprising an area of about

36 a. 0 r. 0 p.

and known as

DURRINGTON WALLS

being Pt. Nos. 123 and 124 on Ordnance Map, having a long frontage to the Amesbury to Devizes Road

and eminently suitable for Building Development

This is let with other lands to Mr F. Toomer on a yearly Michealmas tenancy, the rent for the purposes of this sale being apportioned at £30

OUTGOINGS:- Estimated Commuted Rectorial Tithe £12 : 14 : 1

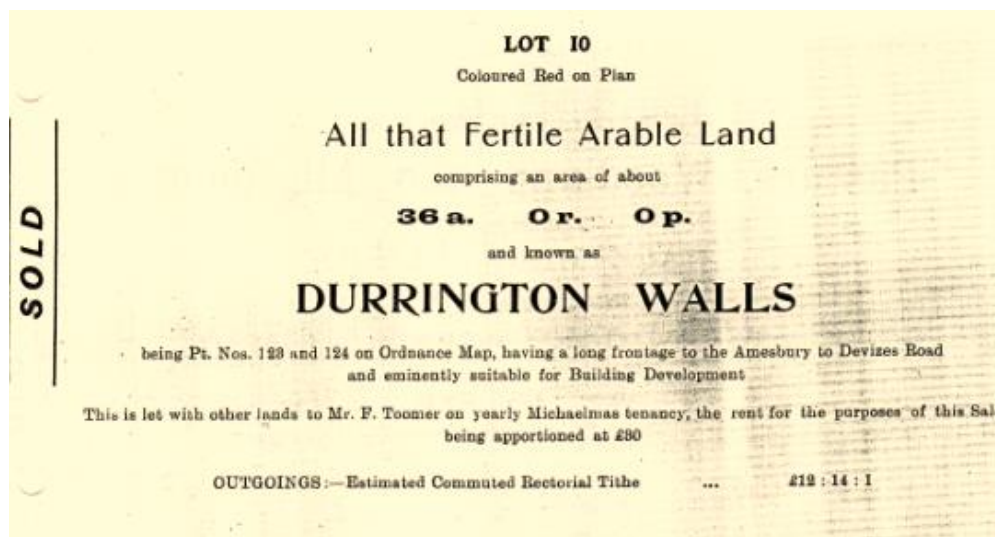

(For sale advertisements from 1921 – with thanks to Dave Healing)

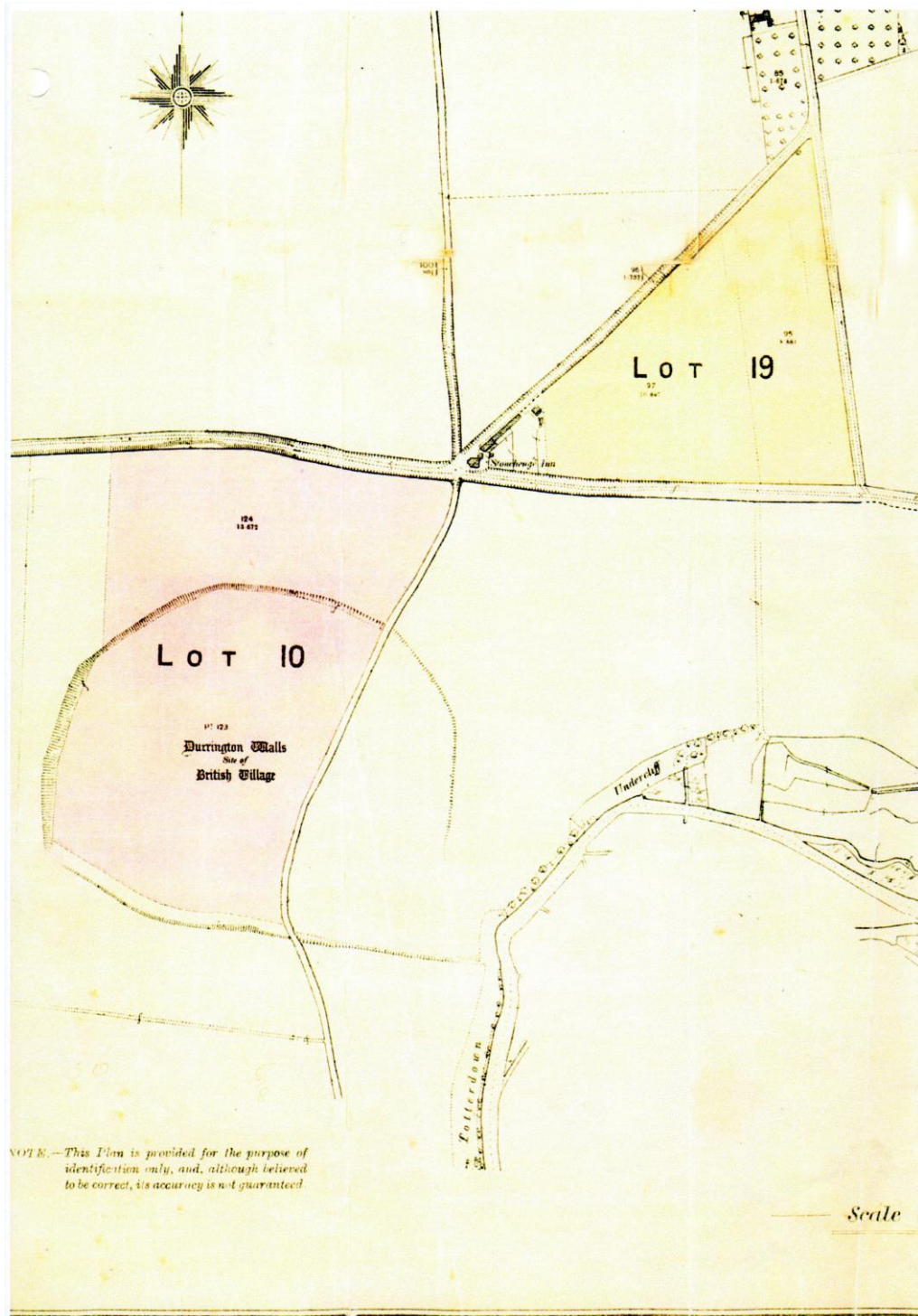

Bottom left of section map of Durrington showing Properties for sale in 1921

(See separate document showing entire Map)